



Spinning Wheel Mead, Harlow, CM18 7AQ
£210,000



Spinning Wheel Mead, Harlow, CM18 7AQ

This two double bedroom top floor apartment is beautifully presented throughout, with a balcony overlooking Latton Common, vaulted ceilings and is located in the popular turning of Spinning Wheel Mead. Inside there is an entrance hallway leading to a large, open plan dining area and lounge, a modern fitted kitchen with a range of wall and base units, a balcony, two double bedrooms and a stunning family bathroom with a modern white three piece suite. Spinning Wheel Mead is located just off Commonsides Road, with Latton Common, excellent schools and shops within walking distance, plus the M11 close by. Lease Remaining: 96 years. Service Charge: £1465 per year. Ground Rent: £10 per year. Please note, there is a pending section 20 notice on the block, which is why the price has been discounted.

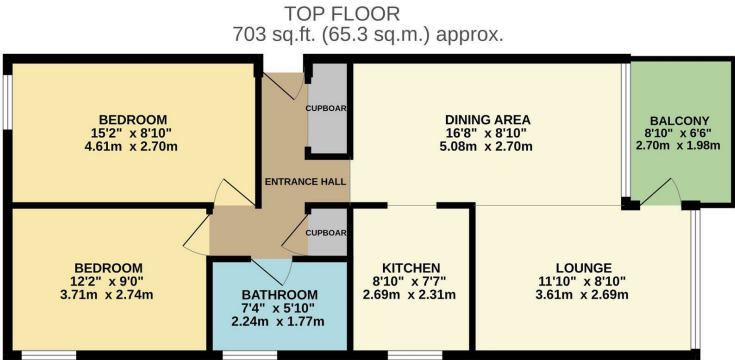

SWM/REYLAND/JOHNSON
TOTAL FLOOR AREA: 703 sq.ft. (65.3 sq.m.) approx.
Whilst every attempt has been made to ensure the accuracy of the floorplan contained here, measurements of doors, windows, rooms and any other items are approximate and no responsibility is taken for any error, omission or mis-statement. This plan is for illustrative purposes only and should be used as such for any prospective purchase. The services, systems and appliances shown have not been tested and no guarantee as to their operability or efficiency can be given.
Made with Neatmap ©2026

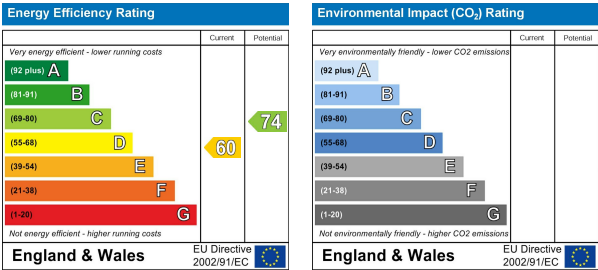
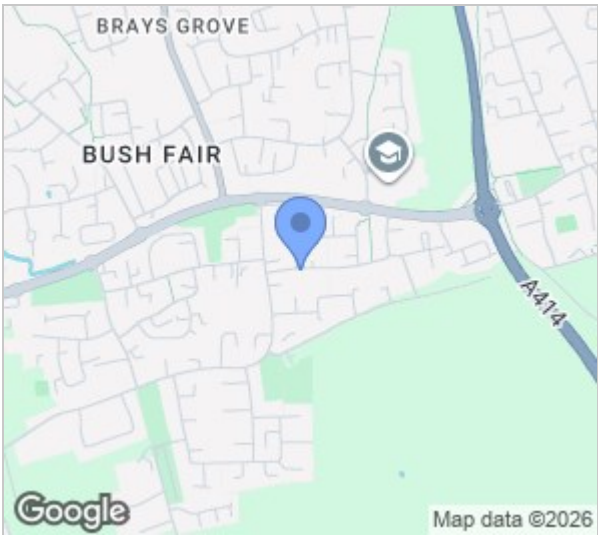

These particulars, whilst believed to be accurate are set out as a general outline only for guidance and do not constitute any part of an offer or contract. Intending purchasers should not rely on them as statements of representation of fact, but must satisfy themselves by inspection or otherwise as to their accuracy. No person in this firms employment has the authority to make or give any representation or warranty in respect of the property.